



# Redondos de Fierro



Medida		Pesos	
Pulgadas	Milímetros	Kg/m	Kg x 6/m
3/8	9.5	0.559	3.35
1/2	12.7	0.994	5.96
5/8	15.9	1.552	9.31
3/4	19.1	2.235	13.41
7/8	22.2	3.045	18.27
1	25.4	3.973	23.84
1 1/8	28.6	5.022	30.13
1 1/4	31.7	6.208	37.25
1 3/8	34.9	7.514	45.08
1 1/2	38.1	9.000	54.00
1 5/8	41.3	10.490	62.94
1 3/4	44.4	12.170	73.02
2	50.8	15.890	95.34
2 1/4	57.1	20.110	120.66
2 1/2	63.5	24.830	148.98
3	76.2	35.766	214.60

# Semiflecha Redondo Pulido

Diámetro General		Peso	
mm.	Pulg.	Kg./m	kg./pza.
12.7	1/2	0.994	5.960
11.1	7/16	0.770	4.600
9.5	3/8	0.599	3.590
7.9	5/16	0.388	2.330
6.3	1/4	0.249	1.490
4.7	3/16	0.146	0.880

# Canal U CPS

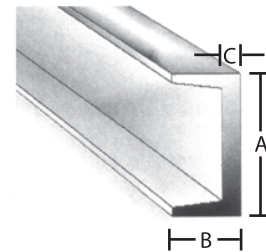

La Canal "U" viene en tramos de 6.10 y 12.20 mts.

# Viga IPS Tipo americano

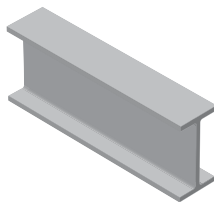

PERALTE d		PESO	AREA	PESO Kg.
mm	pulg.	Kg/m	cm <sup>2</sup>	6.10m.
76.2	3	8.48	10.52	51.73
101.6	4	11.72	14.26	71.50
127.0	5	15.08	18.52	92.00
152.4	6	18.60	23.29	113.46
203.2	8	27.38	34.39	167.02

## PROPIEDADES DE CANAL "U"

PERALTE		PATIN		ALMA mm. (C)	PESO	
mm. (A)	Pulg. (A)	Ancho mm. (B)	Espesor mm. (B)		Kg/m.	Kg. Pza. 6.10 m
76.2	3	35.8	7	4	6.10	37.21
101.6	4	40.1	8	5	8.04	49.04
152.4	6	48.8	9	5	12.20	74.42
152.4	6	52.0	9	8	15.63	95.34
152.4	6	55.0	9	11	19.35	118.04
203.2	8	57.9	10	6	17.11	104.37
203.2	8	60.0	10	8	20.46	124.81
203.2	8	64.0	10	12	27.90	170.19
254.0	10	66.0	11	6	22.80	139.08
254.0	10	70.0	11	10	29.80	181.78
254.0	10	73.0	11	13	37.20	226.92
254.0	10	73.0	11	17	44.70	272.67
304.8	12	75.0	13	7	30.80	187.88
304.8	12	77.0	13	10	37.20	226.92
304.8	12	81.0	13	13	44.64	272.30

Av. Viaducto Tlalpan No. 425,  
Col. San Lorenzo Huipulco,  
Tlalpan, México, D.F., C.P. 14370  
Tels. 5573-3026 / 5573-2917  
5573-2979 / 5573 2879  
5573-2993 / 1315 0095  
5513-8569 / 5513-8574



[www.viaductotalpan.com.mx](http://www.viaductotalpan.com.mx)